

Barrier Solar Lamp

Code: VI-BA-140

Images are merely illustrative models.

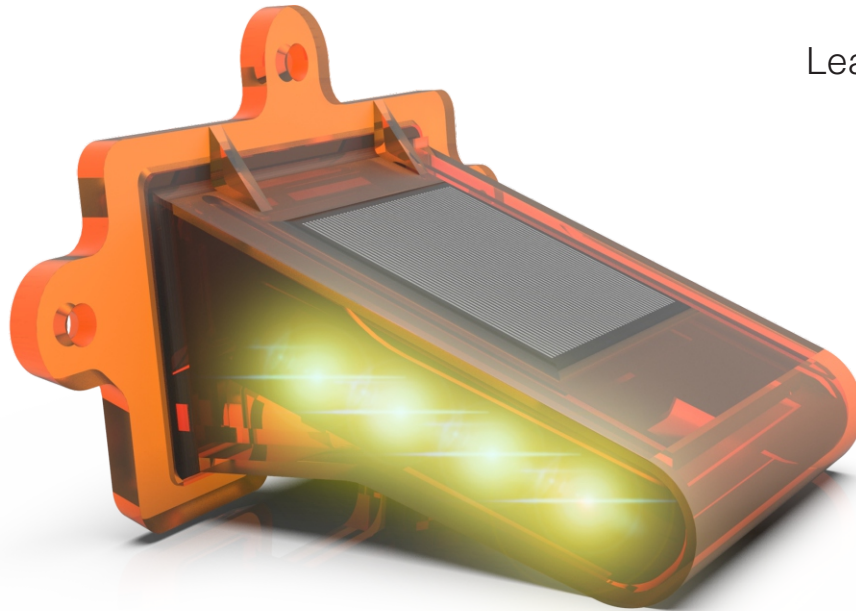

Leader don't follow steps
... marks the way

FEATURES

- Rounded body with no sharpen edges.
- Very important warning night element.
- Autorechargeable, with auto turn on/off sensitive to light conditions, turn off in day and on, during nights.
- Easy handle and installation.
- Efficient design applying solar technology and 4 ultrabright leds.
- Great visibility on any weather condition.
- Has a solar panel area to get enough illumination for a "long distance visibility".

Luminous System

- **Manufactured out in:** Polycarbonate UV protected.
- **Body color:** Amber.
- **Measure:** Length: 5.51 in., width: 3.34 in., height: 3.5 in.
- **Water absorption:** waterproof.
- **Solar panel:** Silicon.
- **solar panel measure:** L: 0.21 in., w: 0.21 55 in..
- **Color led:** Red or amber/ High intensity.
- **Leds:** 4.
- **Led intensity:** + 10,000 Microcandels.
- **2 long life rechargeable batteries** NK-MTH.
- **Flasher light sequence:** 70 flashes per minute.
- **Led visibility from distance:** 211 yds.
- **Circuit efficiency:** (48 hrs) operation by charge (5 hrs).

WHAT IS THE BARRIER SOLAR LAMP ?

The Barrier Solar Lamp is a device manufactured in high resistance polycarbonate plastic amber color.

With an auto-rechargeable system by a solar cell with a photosensor to auto turn on/off.

Illumination by high intensity leds amber or red in flashing mode.

To install or central or lateral barriers in highways or in tunnels walls.

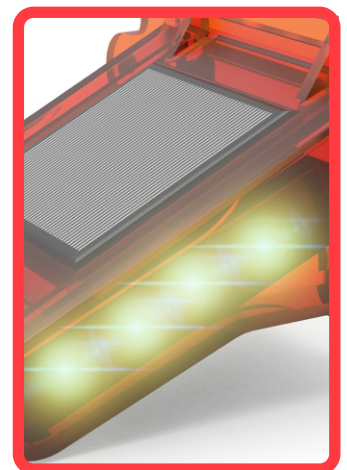

Barrier Solar Lamp

Code: VI-BA-140

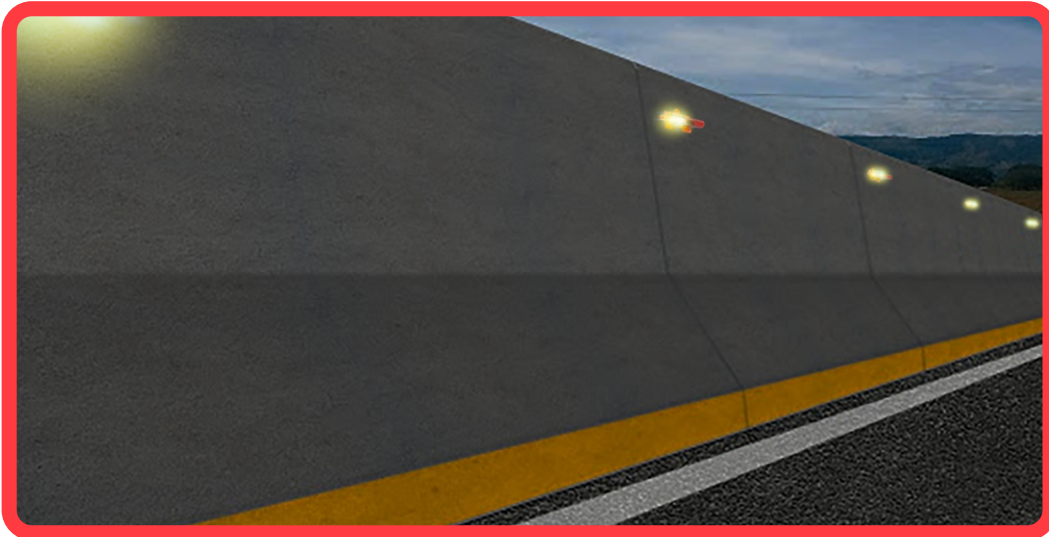

Anchorage procedure:

- 1.- Clean the barrier to get free of dust or oily substances.
- 2.- Clean the device for a better performance too.
- 3.- Prepare the epoxic glue making the mix. Each Barrier Lamp uses 2,82 oz.
- 4.- Optional installation by shoot powder tool or riveter. Each device requires 3 shoots.

Measures are nominal and can vary between +/- 2%.

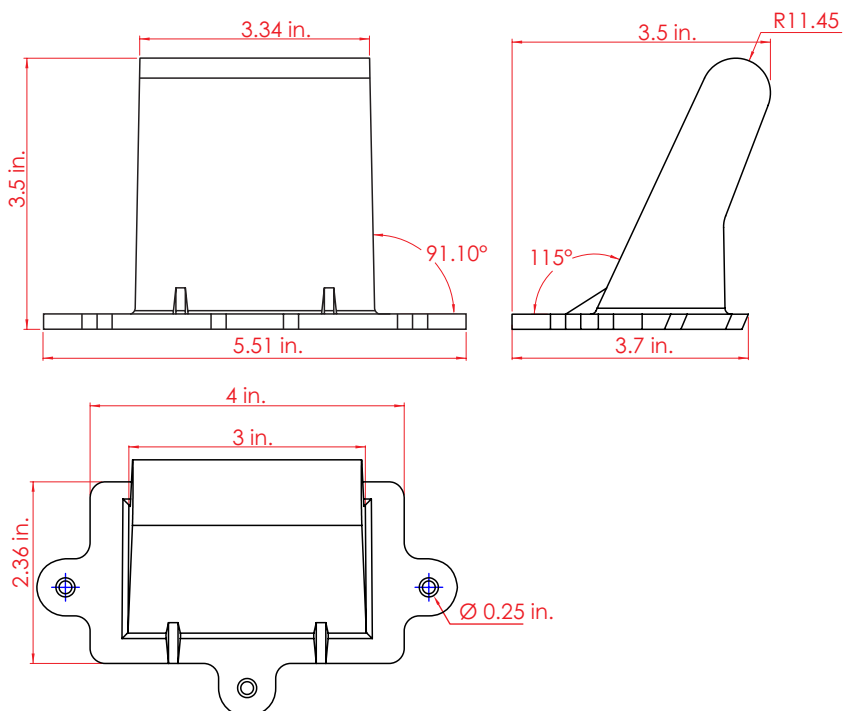

Installation elements:

1. Barrier Solar Lamp
- 2.- Central barrier or tunnel to place it.
- 3.- Epoxic glue.
- 4.- Shoots (optional) or rivets.

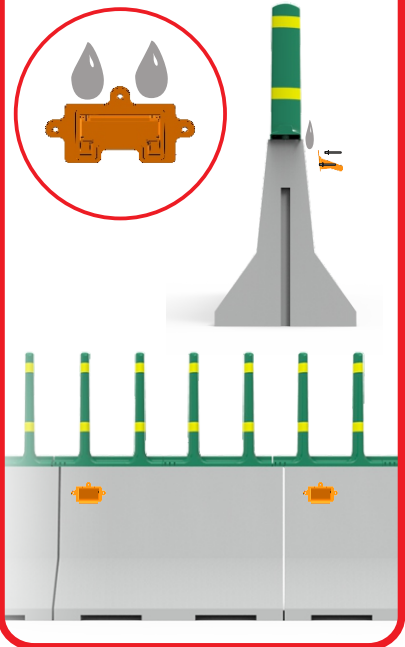
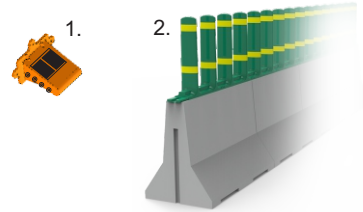

Measure:

Length: 5.15

Reflective:

Width: 3.34 in.
Height: 3.5 in.
4 lateral leds

Led Color:

Red or amber